

BASEMENT LEVEL

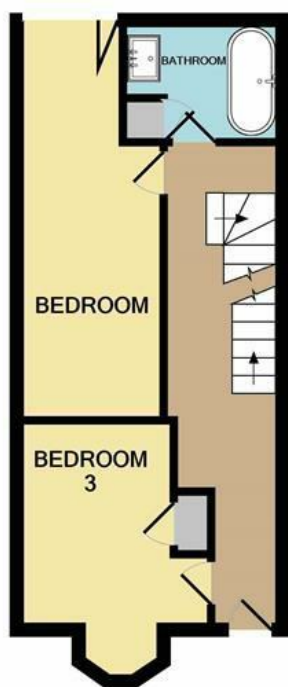

GROUND FLOOR

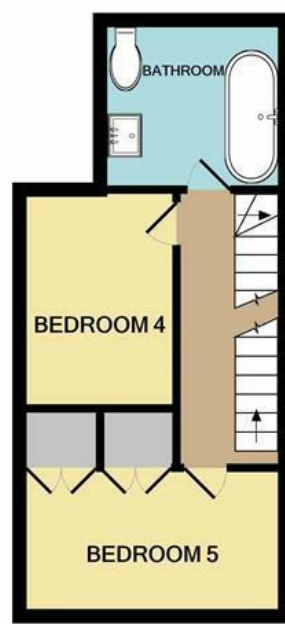

1ST FLOOR



2ND FLOOR

Whilst every attempt has been made to ensure the accuracy of the floor plan contained here, measurements of doors, windows, rooms and any other items are approximate and no responsibility is taken for any error, omission, or mis-statement. This plan is for illustrative purposes only and should be used as such by any prospective purchaser. The services, systems and appliances shown have not been tested and no guarantee as to their operability or efficiency can be given
Made with Metropix ©2021

Energy Efficiency Rating

	Current	Potential
Very energy efficient - lower running costs		
(92 plus) A		
(81-91) B		
(69-80) C		
(55-68) D		
(39-54) E		
(21-38) F		
(1-20) G		
Not energy efficient - higher running costs		
England & Wales		EU Directive 2002/91/EC

Disclaimer – In accordance with the Property Misdescriptions Act, the company gives notice that all descriptions, references to condition, necessary permissions for use and other details are given in good faith and believed to be correct, but any intending lessees do not rely on them as statements of fact, but must satisfy themselves by inspection or other means, as to their accuracy.



Mill Hill Road | Norwich | NR2
Per Month £3,300 Per Month



Luxury student let abbotFox are pleased to offer this six-bedroom property located in the popular golden triangle just off Unthank Road. Suitable for both UEA and NUA students, this property has been recently refurbished throughout. The basement level offers a modern kitchen and entertaining area with access to a rear garden, shower/utility room and a bedroom with independent access. The ground floor benefits from three double bedrooms and a four-piece bathroom. The first floor comprises two further double bedrooms and a second, four-piece bathroom. The top floor offers a double bedroom with an ensuite shower room.

Please call today to avoid disappointment, a video tour of the property can be provided upon request.

